

CHECK VALVE
CX1

USER'S MANUAL



SAFETY GUIDE

The model CX1 is a stainless steel Check Valve which is used to prevent the backflow of a fluid. The connection uses a ferrule, making it easy for maintenance. It is an in-line type that is not restricted by the installation orientation and allows compact piping. It can be widely used in steam or water (hot water) piping and other applications.

In order to get maximum benefit from this product, be sure to read this manual before installing it.

The following warnings and cautions are shown at appropriate places in this manual.



Failure to observe this type of precaution may lead to serious injury or death.



Failure to follow this type of precaution can lead to injury or damage to equipment and property.

Table of Contents

1. SPECIFICATION AND MARKING	1
2. CONSTRUCTION DETAILS	2
3. INSTALLATION	2
4. TROUBLESHOOTING	2
5. MAINTENANCE	3
6. WARRANTY	4
7. SERIAL NUMBER (S.No.) DESIGNATION	5
8. GUIDANCE FOR READING SPECIAL PRODUCT NAME	6

1 SPECIFICATION AND MARKING



WARNING

Be sure not to use this product at higher pressures than the specified maximum operating pressure (PMO) or at temperatures higher than the specified maximum operating temperature (TMO).

The following items are displayed on the name label, the side of the product or drawing. Check each item to avoid misuse of the product.

- 1) Maximum allowable pressure (PMA): 1.0 MPa (145 psig)
- 2) Maximum allowable temperature (TMA): 250 °C (482 °F)
- 3) Maximum operating pressure (PMO): 0.5 MPa (73 psig)
- 4) Maximum operating temperature (TMO): 220 °C (428 °F)
- 5) Cracking pressure: 0.003 MPa (0.435 psig) or less
- 6) Size: 38mm (ISO 2852, Ferrule)
- 7) Year of production: The two leftmost digits in the four-digit, six-digit or nine-digit 'S No.' on the name plate are the last two digits of the year of production.
- 8) Flow direction: Shown by an arrow
- 9) Body material: Stainless steel SUS316
- 10) Model symbol: Showing the product model name

Some pictures and illustrations in this manual are that of the representative model. For more details regarding dimensions and other specifications, please refer to the catalog.

2 CONSTRUCTION DETAILS

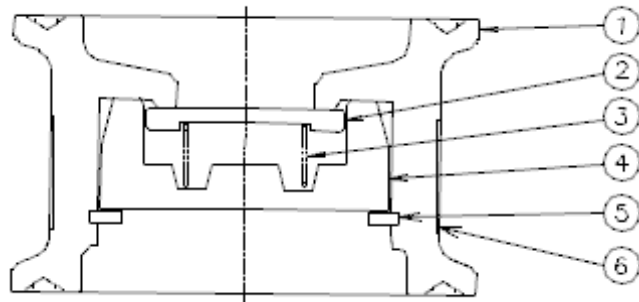

1. Body
2. Disc
3. Spring
4. Retainer A
5. C-ring
6. Name plate

3 INSTALLATION



CAUTION

- Before installing the product, blow out any debris or dirt inside the pipeline.

- 1) Check the flow direction indicated on the name plate.
- 2) There is no restriction on the installation orientation.

4 TROUBLESHOOTING

Problem	Possible cause	Solution
Backflow	Foreign substances stuck between the disc (2) and the body (1).	Disassemble and remove the foreign substances.
	The disc (2) and the body (1) are worn.	Replace with a new one.
	The spring (3) is damaged.	Replace the spring (3) with a new one.
No fluid flow	The disc (2) and the body (1) stuck to each other.	Clean the disc and cover.
	Wrong installing direction	Reinstall the product in the correct direction.

5 MAINTENANCE



WARNING

- When you remove or disassemble the CX1 from piping, make sure that the inside pressure is 0 MPaG (0 kgf/cm²•g) and the body surface temperature is at room temperature before starting the work in order to ensure safety.



CAUTION

- Both faces of the body are sealing surfaces. Be careful not to damage them.

5-1. Disassembling procedure

- 1) When you remove the C-ring (5) from the body (1), all internal parts can be taken out in the order of the retainer A (4), the spring (3), and the disk (2).

5-2. Assembling procedure

After inspecting and cleaning the body (1) and each part, assemble them with the following procedure.

- 1) Place the body (1) on a stable surface with the outlet side facing upward.
- 2) Place the disc (2) on the center of the seat surface of the body (1) with the recessed side facing upward and set the spring (3) on the recessed section of the disc.
- 3) Set the retainer A (4) so that the tip contacts with the body (1). At this time, fit the top of the spring in the groove of the retainer A (4).
- 4) Fit the C-ring (5) in the groove inside the body to secure it.

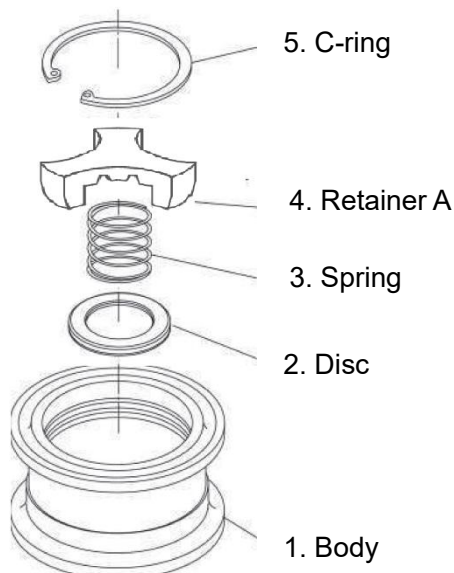

6 WARRANTY

6.1 Warranty period

The warranty period is 18 months after shipment or 12 months after installation, whichever occurs first.

6.2 Details of the warranty

If the product stops working correctly within the warranty period, we will repair or replace the product free of charge if the cause of the trouble is not one of the following items.

- 1) The precautions described in this manual were not observed.
- 2) User's errors or mistakes such as an inappropriate installation or incorrect handling, or an excessively large impact caused by dropping
- 3) Problems caused by devices or equipment other than MIYAWAKI's, or a disallowed use environment
- 4) When a repair or modification has been performed by anyone other than MIYAWAKI or people who are authorized to make such repairs
- 5) Intrusion of salt or other substances that promote significant rust or corrosion or problems from fluids that contain the same substances
- 6) Consumable parts such as Packing, Gasket, O-ring, Diaphragm, etc.
- 7) Attachment or accumulation of foreign matter in the pipe, such as dust and scale
- 8) Problems from fires, natural disasters, or other force majeure which is not MIYAWAKI's responsibility

6.3 Warranty limitation

The remedy available under the warranty shall not exceed the sales price of the products delivered, for any cause whatsoever.

7 SERIAL NUMBER (S.No.) DESIGNATION

The following 4-digit, 6-digit or 9-digit “S. No.” is displayed on the product.

	Display				Example of serial number designation
		(A)	(B)	(C)	
4-digit	S.No.	□ □ □ □			S.No. 1 7 1 1 → Jan.1, 2017
					S.No. 2 9 X M → Oct. 21, 2029
6-digit	S.No.	□ □ □ □ □ □			S.No. 1 7 9 1 0 1 → Jan.1, 2017
					S.No.2 9 X F 2 1 → Oct. 15, 2029
9-digit	S.No.	□ □ □ □ □ □ □ □ □			S.No. 1 7 1 1 2 C 0 2 0 → Jan. 1, 2017
					S.No. 2 9 X T 5 M 0 5 0 → Oct. 28, 2029

Notes

(A)

Represents the year of production.

Last two digits of the year according to the Western calendar.

(B)

Represents the month of production. See following table.

Month designation system

Month	1	2	3	4	5	6	7	8	9	10	11	12
Symbol	1	2	3	4	5	6	7	8	9	X	Y	Z

(C)

Represents the day of production. See following table.

Day designation system

Day	1	2	3	4	5	6	7	8	9	10	11	12
Symbol	1	2	3	4	5	6	7	8	9	A	B	C

Day	13	14	15	16	17	18	19	20	21	22	23	24
Symbol	D	E	F	G	H	J	K	L	M	N	O	P

Day	25	26	27	28	29	30	31
Symbol	Q	R	S	T	U	V	W

(D)

6-digit or 9-digit : Represents MIYAWAKI identification number.

8 GUIDANCE FOR READING SPECIAL PRODUCT NAME

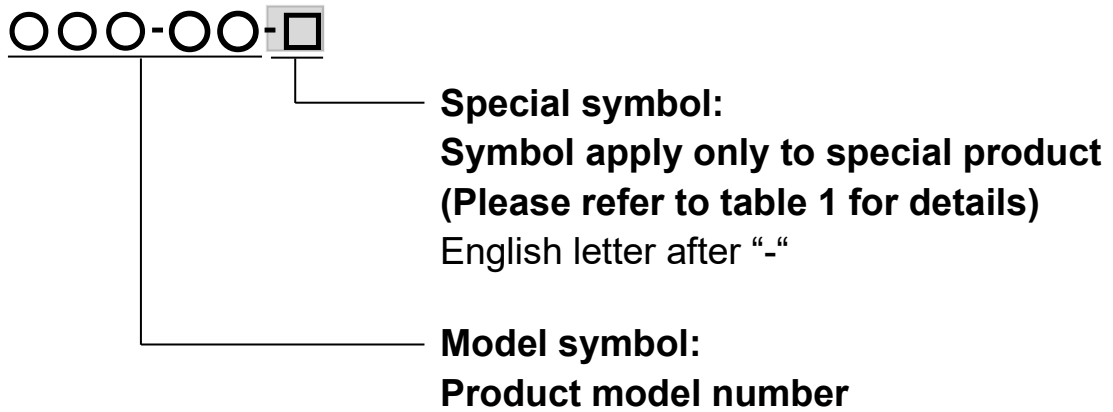

Table 1 Symbol description

Suffix	Special contents
A	Trap for high-pressure gas installed property (only for Gas Trap)
C	Blow valve attached
K	Change of gasket
L	Special face to face dimension
M	Change of parts material
P, T	Change of operating pressure, temperature, condensate capacity, etc
R	Change of screen mesh
V	Change of air vent
X	Other than mentioned above or complex of special contents above

-
- For any questions about the product that you purchased or about the details in this user's manual, please contact the following.
 - © 2026 MIYAWAKI INC.
This user's manual may not be reproduced or copied in whole or in part, without the written consent of MIYAWAKI INC.
 - Some special specifications of the product you have, may found to be different from the ones in the user's manual. If you have any question, please contact MIYAWAKI, our local authorized agent, or the place where you purchased.
-



If you need any assistance regarding this manual, please contact MIYAWAKI INC.'s International Sales Dept. or its local representative. By scanning QR Code, you can access inquiry form.



INTERNATIONAL SALES DEPT.
2-1-30, Tagawakita, Yodogawa-ku, Osaka, 532-0021, Japan
Tel: +81-6-6302-5549
www.miyawaki-inc.com/en e-mail: export@miyawaki-inc.co.jp

EU Importer and Authorized representative:



Birnbaumsmühle 65, 15234 Frankfurt (Oder), Germany
Tel: +49-335-4007-0097
www.miyawaki-inc.com/de e-mail: info@miyawaki.de

China Importer and Authorized representative:



Room 902, Building 8, Huaqing Chuangzhi Park, No.3 Qingyan Road, Huishan District, Wuxi City Jiangsu Province, China
Tel: +86-510-8359-5125
www.miyawaki-inc.com.cn e-mail: mywkwest@miyawaki-inc.com.cn

Korea Importer and Authorized representative:



#1801, 3 Gongwon-ro, Guro-gu, Seoul, Republic of Korea (08298)
Tel: +82-2-837-9307
www.miyawaki-inc.com/ko e-mail: mkt@miyawaki.co.kr

808174-00 2601

CX1